

1/33 Birriga Road Bellevue Hill NSW

2 2 1

This exquisite single-level garden apartment offers a luxurious sanctuary with a tranquil sense of peace and privacy. The two-bedroom home opens to a lush landscaped garden with an entertainer's terrace and is situated at the back of a boutique collection, providing direct access to secure covered parking. With a private entrance and an elegant master suite, this thoughtfully appointed residence is nestled between the coastal attractions of Bondi Beach and Rose Bay harbor, just 300m from Bellevue Park.

Price : \$ 1,680,000

View : <https://www.onlinerealestateagents.com.au/sale/nsw/eastern-suburbs/bellevue-hill/residential/apartment/8005242>

? Part of an exclusive boutique collection of seven with secure entry and covered parking

? Two generously sized bedrooms with built-in wardrobes

? Open-plan living and dining area seamlessly flows to a level child-friendly garden



Majid Mokhtari
0400657657



Joseph Raskin
0474 336 736

Unit 1, 33 Birriga Road, Bellevue Hill



2 Bed 2 Bath 1 Car

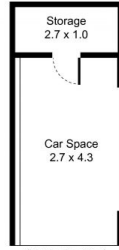

(Not In Position)
CAR SPACE

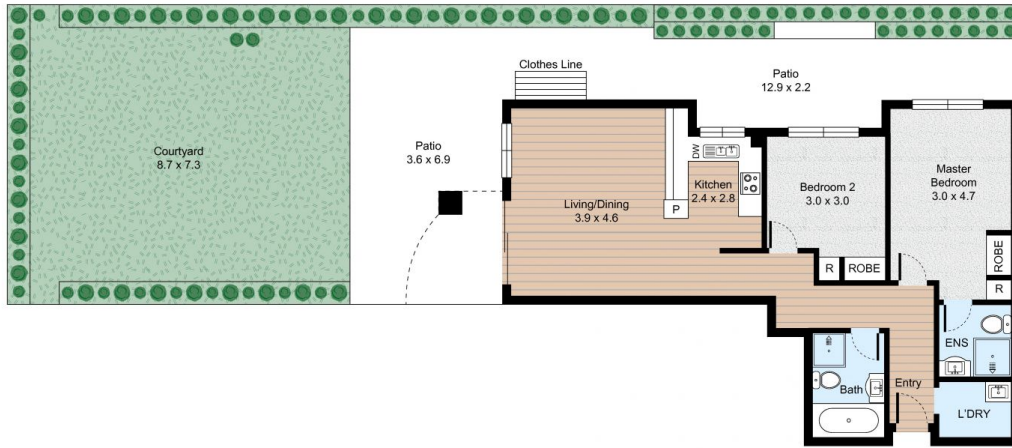

Internal : 75m²
External : 128m²

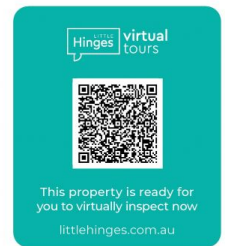

FLOOR PLAN



All information contained herein is gathered by Little Hinges. Whilst the scanning technology is highly reliable, we cannot guarantee its accuracy and interested parties should rely on their own enquiries.